

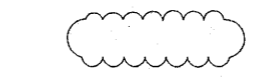

LAND AREA
Total 1,759,799 s.f. 40.3994 Acres

FLOOR AREA RATIO
0.24:1.0

PARKING
Parking spaces Total 428 spaces

TREE AND SHRUB LEGEND

-  SCREENING HEDGE
-  TREE
-  BUILDING IDENTIFICATION

BUILDING AREA
Allowable Total 421,679 s.f.

LOT COVERAGE
Allowable Total 310,565 S.F. 17.6%

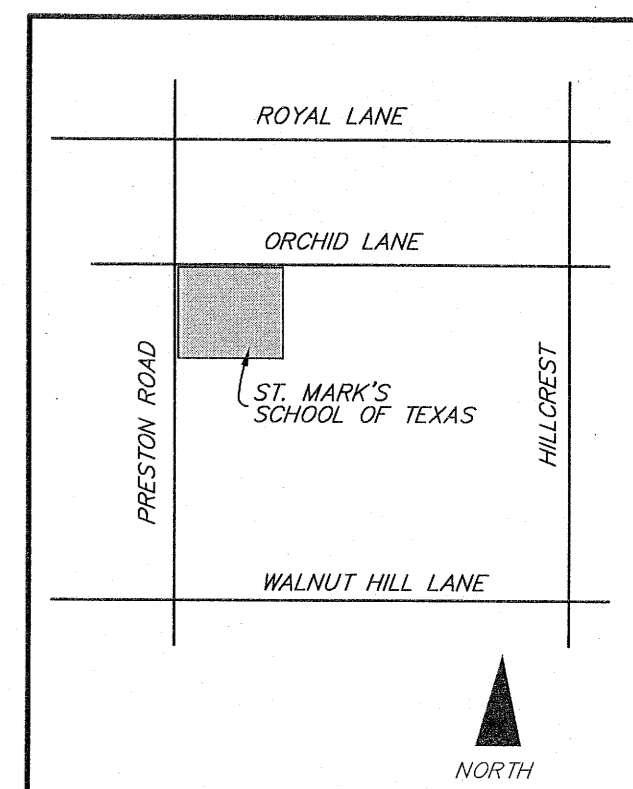
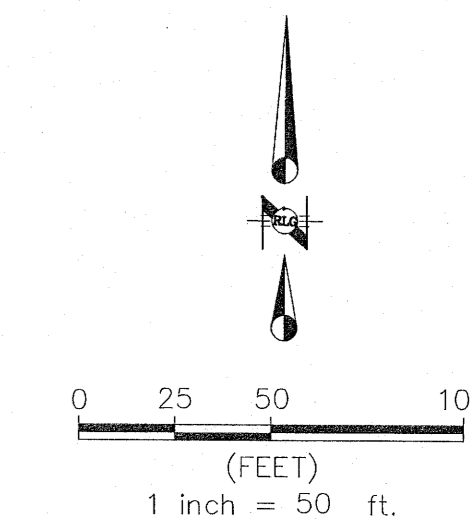

LOCATION MAP

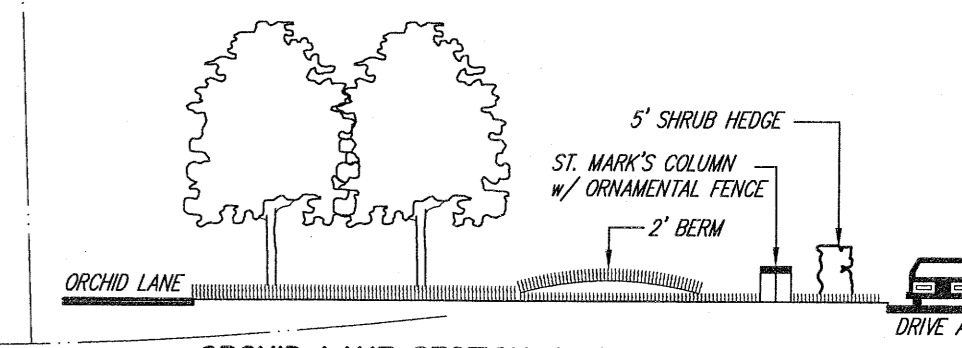

ORCHID LANE SECTION A-A

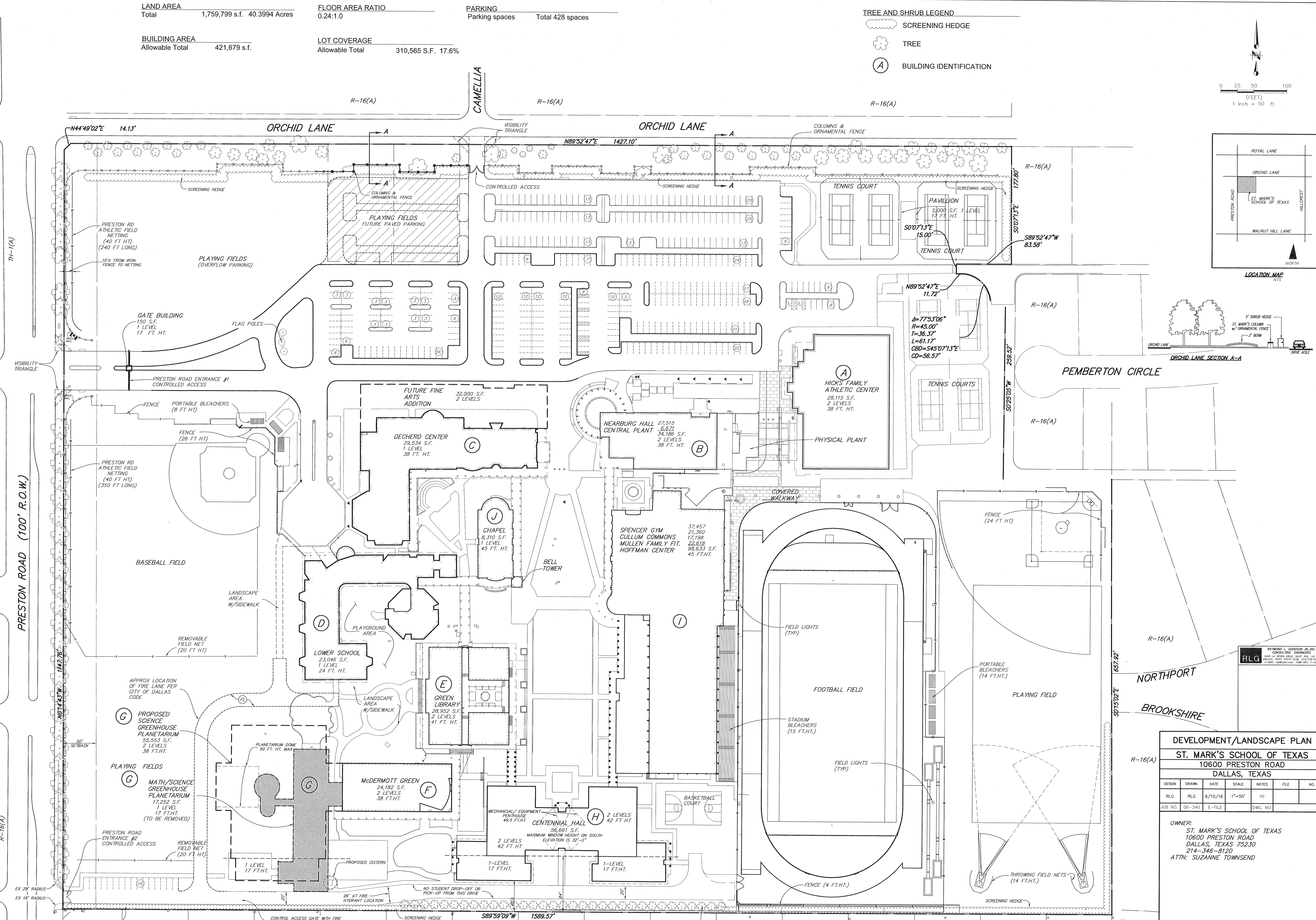

DEVELOPMENT/LANDSCAPE PLAN					
ST. MARK'S SCHOOL OF TEXAS					
10600 PRESTON ROAD					
DALLAS, TEXAS					
DESIGN	DRAWN	DATE	SCALE	NOTES	FILE NO.
RLG	RLG	6/10/16	1"=50'	FD	
JOB NO.	06-340	E-FILE	DWG. NO.		

OWNER:
ST. MARK'S SCHOOL OF TEXAS
10600 PRESTON ROAD
DALLAS, TEXAS 75230
214-346-8120
ATTN: SUZANNE TOWNSEND

215a-218
CASE NO. 2401-H3(RB)

FILE LOCATION: P:\Dwg\2015\20150628 ST. Mark's School Building\20150628.dwg; PLOT DATE/TIME: 6/10/2016 1:12:27 PM; PLOT: R:\Users\rlg